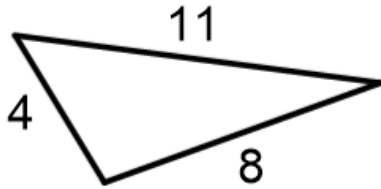
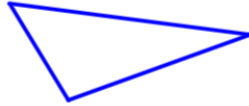
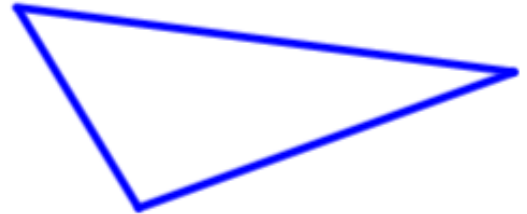

**CORRECTIVE ASSIGNMENT**

Label the sides of the similar figures with the given scale factor.

1.

Original Triangle

Scale Factor =  $\frac{3}{4}$ Scale Factor =  $\frac{7}{5}$ 

Set up a proportion and then solve it!

- The scale on a map says that 1.5 cm = 5 km. You plan to hike 4 cm on the map. How many kilometers is that in real life?
- The key of a map states 2 inches is 25 miles. If you drive 680 miles, how far is that on the map?
- A model of a car was made using a scale of 1:15. If the size of car in the model is 8 in, then find the actual length of the car.
- The model of a skyscraper is 25 in: 640 ft. If the skyscraper is 800 feet tall, how tall is the model?
- The scale is 2 units = 19 feet. What are the real-life dimensions of the hallway?
- The scale is 3 units = 20 feet. What are the real-life dimensions of the kitchen?

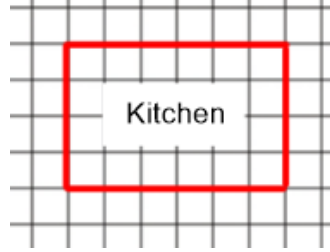
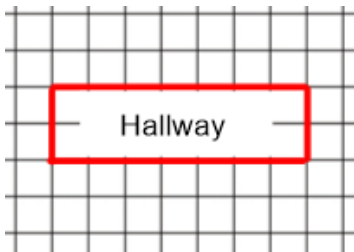
**ANSWERS TO CORRECTIVE ASSIGNMENT**

1.	<p>3, 6, 8.25</p>	<p>5.6, 11.2, 15.4</p>	2. $13.\bar{3}$ km	3. 54.4 in	4. 120 in
			5. 31.25 in	6. $66.5' \times 19'$	7. $40' \times 26.\bar{6}'$